

PROSTOR™

GOLF Rack

Model | PG-2R

1

Mounting Rack

Locate stud. Make sure rack is vertically positioned on stud and mark holes through mounting plates at desired height. Pre-drill 1/8" pilot holes and install rack with provided mounting screws; tighten firmly.

2

Storing Equipment

Golf bags are stored on rack by hanging either carrying handles or shoulder straps over side hooks, located at top of rack. Shoes may be stored upside down or right side up by placing shoes over wire loops. *Weight not to exceed 50 lbs.*

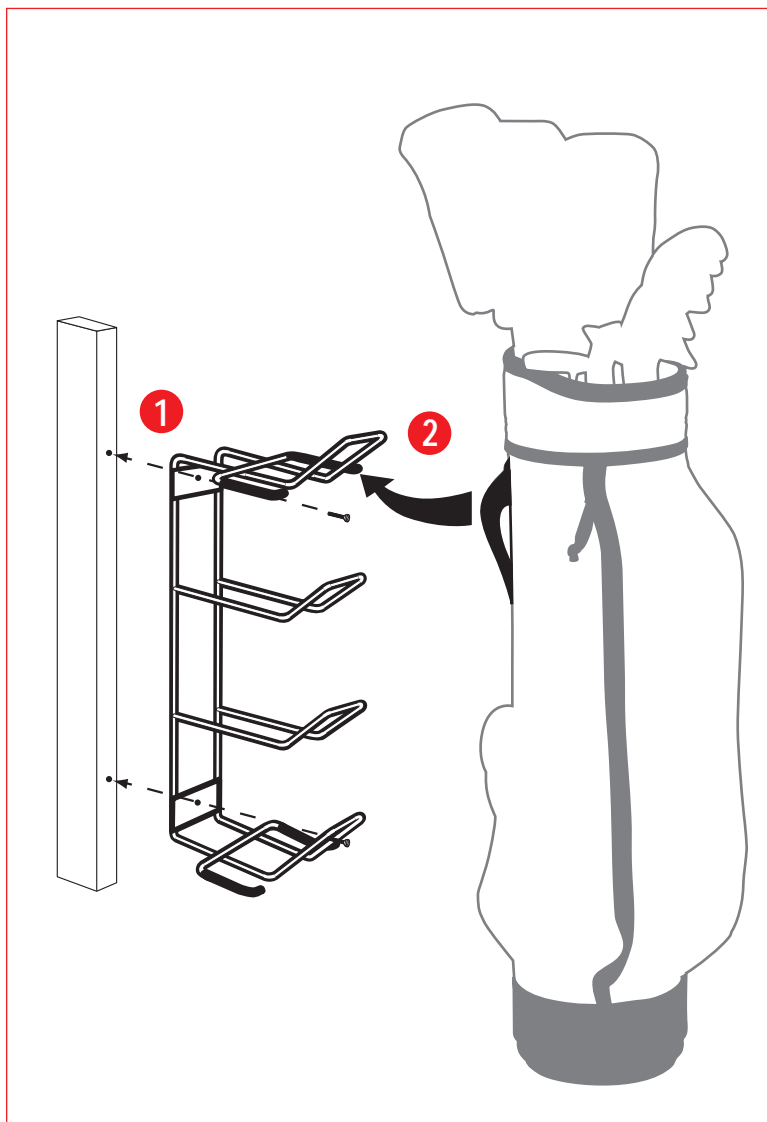

Warning: Please read installation instructions carefully prior to installing rack. Before using the rack, thoroughly test the fully-weighted rack (with equipment in place) to insure the rack has been installed securely and is functioning properly. Racor, Inc. is not responsible for any damage resulting from improper installation, overloading or product failure.